

 **Dimplex**[®]

Operational Guide



opti-myst[®]

Contents

03 What should Opti-myst look like?

04 Opti-myst Components

05 What do I need to do?

08 Do's and Don'ts

09 Troubleshooter

10 Q+A

11 Important Contacts

What should an Opti-myst look like?



Opti-myst components

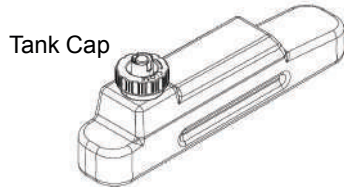

Tank Cap

Water Tank:
Ensure that the water tank is filled with filtered water.
See 'Filling the water tank' in your instructions



Transducer Unit

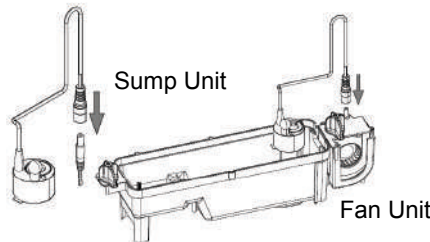

Sump Unit

Fan Unit

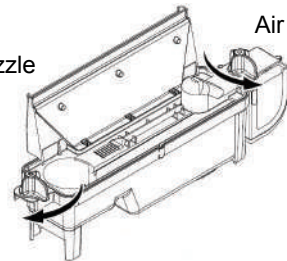

Nozzle

Air Filter

THE MAGIC OF AN OPTI-MYST FIRE

There's nothing quite like the effect of a fire. It creates a wonderful feeling of comfort and cosiness. Looking deceptively real, an Opti-myst fire will captivate you from the moment you see it. The fully 3-dimensional effect creates authentic looking 'flames' and 'smoke' delivering a warm and cosy atmosphere to any room.



Revolutionary technology

The flame and smoke effect is created using ultrasonic waves which atomise water to create an extremely fine mist. This is not steam since the water is at room temperature and, therefore, the "flames" are safe to touch.

As the mist is so fine it does not add significantly to the humidity of the room.

Realistic fire effect

After much testing, Dimplex has fine-tuned the ultrasonic transducer to produce the most realistic flame and smoke effect possible.

Special effect lighting

The light bulbs have two functions in an Opti-myst fire. The heat produced enables the water mist to rise up through gaps in the log fuel bed in a flame-like manner. They also illuminate the water mist with the orange glow of a real fire. These bulbs are dichroic, enabling an accurate representation of flame-like colour.

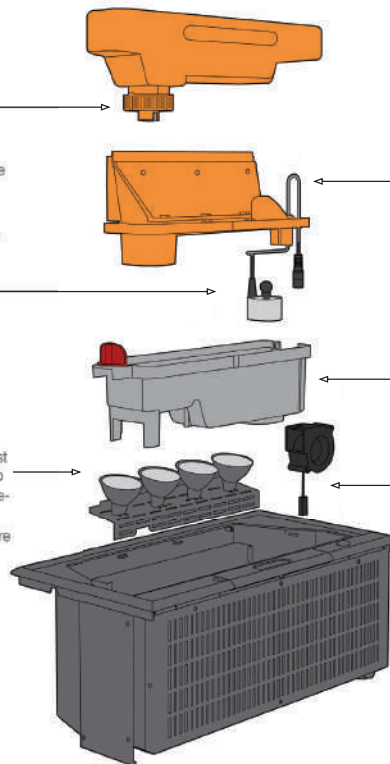

"The Opti-myst effect is just great. It's the only product out there that can give this level of realism." A satisfied customer.

Anti-microbial additives

For added peace of mind, an anti-microbial substance has been added into the plastic material used in Opti-myst fires.

Also, a study at the Microbiology Department, University College Cork concluded that the unit offers no risks to use from a microbiological perspective.

Easy to clean

It is recommended to use filtered water Opti-myst fires. If tap water is used, a build up of limescale can seriously hinder the production of flame and smoke effect. However, if a build up of limescale does occur, the plastic materials used have a highly polished finish to ensure easier cleaning and removal of limescale.

The sump can even be placed in a dishwasher.

Flickering flames

A small fan blows the water mist out of the sump and over the light bulbs. Adjustments of this fan enable the user to control the size of flame arising from their fire.

What do I need to do?

Stoves / Suites



1. Turn off and remove fuel bed



2. Lift water tank out of stove

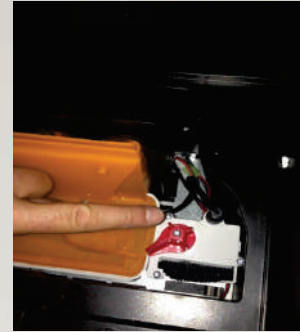

3. Check wires are still secure



4. Fill water tank with filtered water and place back into stove



5. Replace fuel bed back into stove

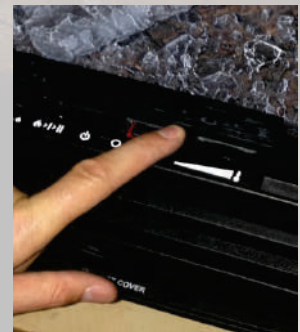

6. Turn on using switch



7. Heating setting and flame only option



8. Control height of flame

When turning on the fire please do the following:

- Switch fire on (0-I).
- Press the flame button.
- Fire will beep to confirm.
- Wait for 30 seconds until you hear a click.
- Flame effect will begin.

What do I need to do?

Wall Fires



1. Turn off and remove pebbles or logs



2. Lift water tank out of wallhung



3. Check wires are still secure



4. Fill water tank with filtered water and replace in wallhung



5. Replace pebbles or logs back into wallhung

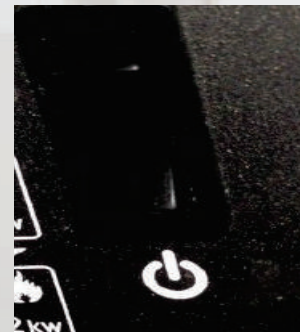

6. Turn on using switch

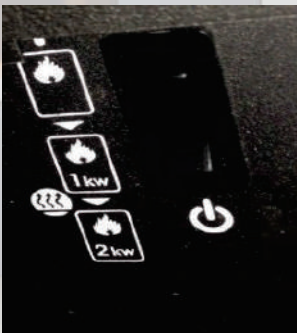

7. Heating setting and flame only option



8. Control height of flame

When turning on the fire please do the following:

- Switch fire on (0-1).
- Press the flame button.
- Fire will beep to confirm.
- Wait for 30 seconds until you hear a click.
- Flame effect will begin.

What do I need to do?

Insets



1. Turn off and remove log bed



2. Lift water tank out of inset

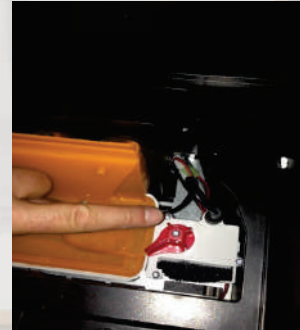

3. Check wires are still secure



4. Fill water tank with filtered water



5. Make sure the water bottle is securely fitted



6. Place log bed back into the fire



7. On and off switch



8. Heating setting and flame only option and height of flame

When turning on the fire please do the following:

- Switch fire on (0-1).
- Press the flame button.
- Fire will beep to confirm.
- Wait for 30 seconds until you hear a click.
- Flame effect will begin.

Do's and dont's



Remember to carry out regular maintenance on the Opti-myst by cleaning the transducer



Don't allow the water to stand for more than two weeks.



Don't use de-ionised water. The auto shut off needs the minerals in the water to detect water level in the sump.



Do use filtered water wherever possible.



Only use the water tank to refill the sump unit.



Remind the customer to register for the second year of the warranty.



Troubleshooter

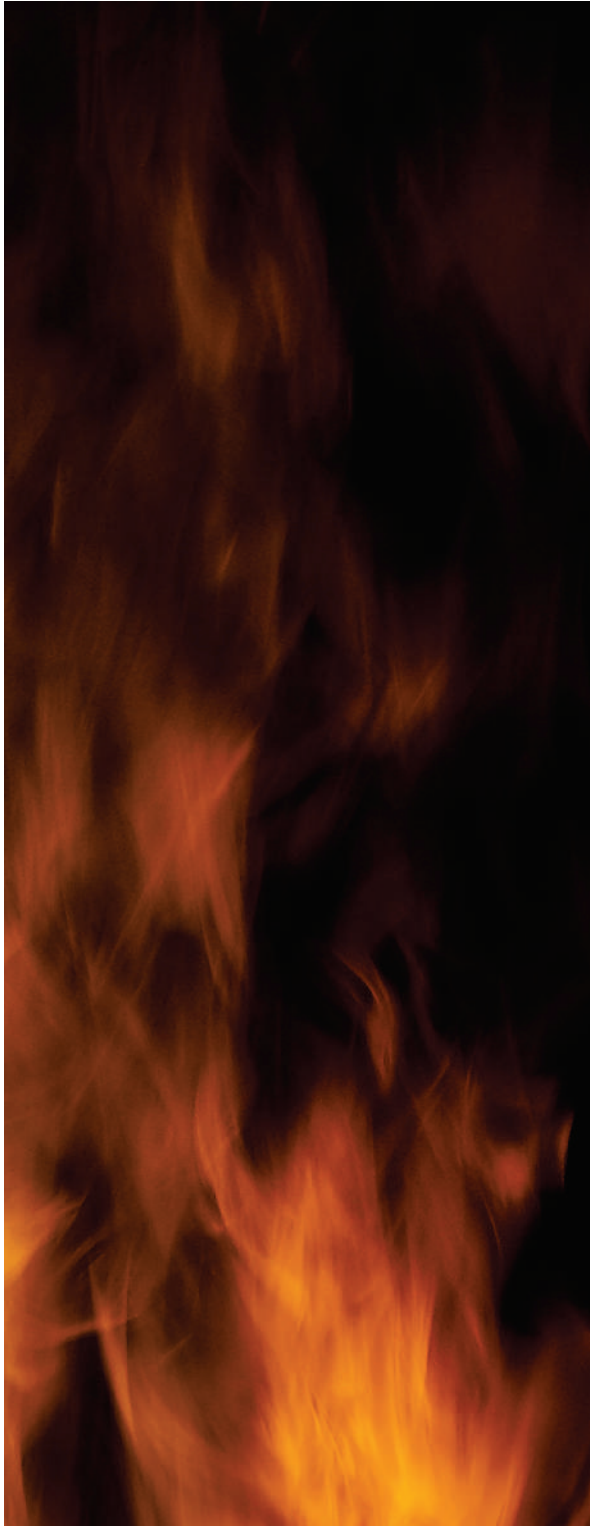

Q. How can I stop the stove door from misting up?

A. Sometimes on start up the stove door can mist up. This will stop when the temperature of the stove equates. You can easily resolve this by opening the stove door slightly and ensuring that the flame effect is turned right down.

Q. Why are the lamps on but there is no flame effect?

A. This is the fan unit which may need to be replaced, a short term solution is to remove the air filter (see pg. 4) and turn the flame effect to maximum.

Q. The Lights are coming on but the unit is not starting?

A. Take out the log set and double check the transducer is working properly. If the transducer is okay check the transducer wire is secure.

Q. Why is the flame effect beginning to look dull?

A. Check that all lamps are illuminated and clean. If the lamp is off ensure it is securely fitted properly, if the lamp stays off the lamps will need to be changed.
(For replacement bulbs please contact Operational Queries.)

Q+A

Q. What is the power consumption when fire is flame only?

A. The Opti-myst fire uses 212 watts when operating in flame only mode.

Q. Will the Opti-myst add to the humidity of the room?

A. No - it is equivalent to having someone else with you in the same room breathing normally.

Q. What lamp does the Opti-myst use?

A. The lamps are 12V,50W, Gus.3 base" beam angle coloured lamps.

Q. Is the Opti-myst easy to clean?

A. Yes - the sump unit, nozzle and water tank can be cleaned with washing up liquid or even go in the dishwasher!



Important contacts

Any queries please contact:

08448 793588

And select option 2

Or

Email us at:

customer.services@gdcgroup.co.uk



Dimplex®